

HOHMANN & BARNARD, INC.
a MiTek company

Flashing and Reglets

Copper Thru-Wall Flashing

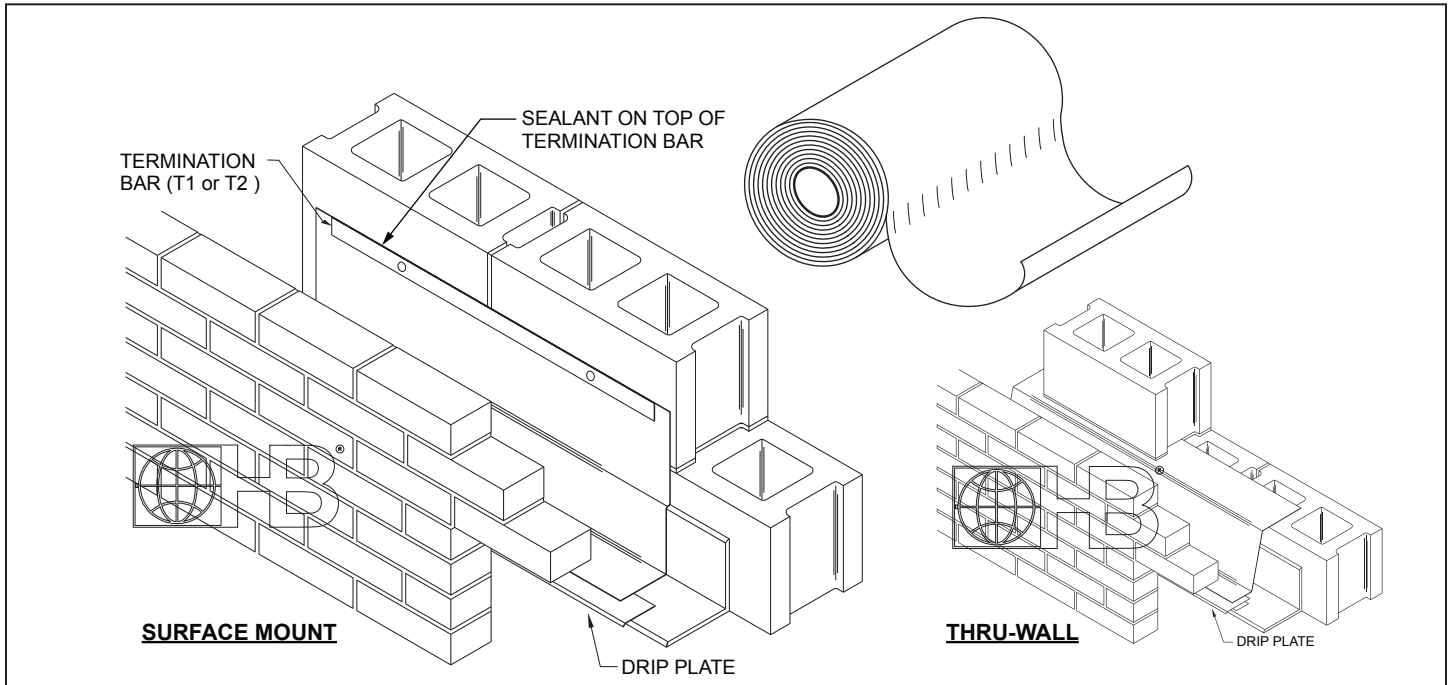

DRAWINGS FOR ILLUSTRATIVE PURPOSES ONLY

Material: Copper sheet used in the fabrication of copper laminates conforms to ASTM B370 (110 Alloy)

C-Coat™ Flashing

- Soft-tempered copper bonded on both sides with an elastic, asphalt compound.
- The flexibility and toughness of copper are combined with the superior water-proofing of elastic, asphalt-compound coating.
- Copper is shielded from acids, alkalis and electrolysis that may be present in uncured mortar joints.
- The asphalt coating is self-sealing in case of puncture.

C-Fab™ Flashing

- Soft-tempered copper bonded on both sides with an asphalt-saturated glass fabric scrim.
- Asphalt-saturated glass fabric adds protection to copper during shipment, while adding another layer of waterproofing and chemical resistance.
- Coarse texture aids in bonding with mortar.

C-Kraft™ Duplex Flashing

- Soft-tempered copper bonded on both sides with creped kraft paper, saturated in waterproofing asphalt.
- End product is lighter weight than C-Fab™, and slightly less expensive.

NOTE:

- An optional stainless steel drip edge is recommended to ensure diversion of moisture to outside of building (product can be cut flush with exterior wall).
- Surface mount applications should be attached with a stainless steel or aluminum termination bar.
- Surface-mount is the preferred method of installation when using air barriers.

*** Please refer to Hohmann & Barnard installation instructions for more information.**

- C-Coat™ Flashing (25-foot roll)
- C-Fab™ Flashing (25-foot roll)
- C-Kraft™ Duplex Flashing (60-foot roll)

Width:

- 12" 16" 18" 20"
- 24" 32" 36" Other _____

Weight:

- 3 oz. 5 oz. 7 oz.

Corners (12 oz.): inside outside end dam

H&B Asphalt Mastic (5 gal. pail)

A high-grade, asphalt-based cement used in bonding asphalt-coated flashing to construction surfaces. It provides a strong, flexible waterproof barrier with excellent adhesion and allows for expansion or contraction caused by temperature fluctuation or building movement.

OPTIONAL: Stainless Steel Drip Plate: (Recommended)

- 1 1/2" 3" Other _____

OPTIONAL: Termination Bar:

(for surface-mount applications)

- | | | | |
|--------------------------|--------------------------|--------------------------|--------------------------|
| STAINLESS STEEL | | ALUMINUM | |
| <input type="radio"/> T1 | <input type="radio"/> T2 | <input type="radio"/> T1 | <input type="radio"/> T2 |

IMPORTANT: Since each construction project is unique, the appropriate selection and use of any product contained herein must be determined by competent architects, engineers and other appropriate professionals who are familiar with the specific requirements of the project in question. This drawing and/or data sheet is the confidential and proprietary information of Hohmann & Barnard, Inc. and is not to be reproduced, copied or disclosed, in whole or in part, without the prior written consent of H&B.

HOHMANN & BARNARD, Inc.
30 Rasons Court | Hauppauge, NY 11788
CORPORATE HEADQUARTERS
T: 800.645.0616 F: 631.234.0683
www.h-b.com

Branch/Subsidiary Locations:
ALABAMA - ARIZONA - ILLINOIS
MARYLAND - NEW YORK
PENNSYLVANIA - TEXAS - UTAH
CANADA

© 2013-2016 MiTek®